

TPX™

HANDLEBAR MOUNT INSTALLATION

ADAPTIV™
TECHNOLOGIES

CONTENTS

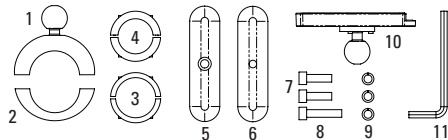

Item No.	Name	Qty.
1	Top Handlebar Clamp	1
2	Bottom Handlebar Clamp	1
3	1" Spacer	2
4	7/8" (22mm) Spacer	2
5	Left Link	1
6	Right Link	1
7	Clamping Screw	2
8	Positioning Screw	1
9	Lock Washer	3
10	Mounting Plate	1
11	5/32" Hex Key	1

This Mount is designed for motorcycles with 1-1/4", 1", and 7/8" (22 mm) diameter handlebars, including most American and Metric Cruisers, and some Touring and Sport Bikes.



Warning: Installation of the Mount should be performed by a qualified technician. Improper installation may interfere with the safety and proper operation of the product and/or vehicle.

1. Place the motorcycle on a center stand and locate an available space on the handlebar for the mount.
2. Using the 5/32" Hex Key, remove the Positioning Screw and Lock Washer to disassemble the Mount as shown in Figure 1.

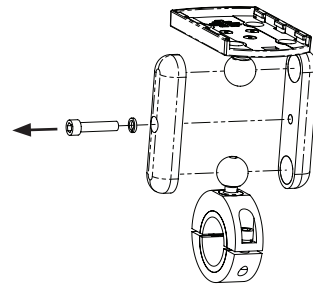

Figure 1

3. Using the $5/32$ " Hex Key, disassemble the bottom portion of the Mount and reassemble onto handlebar as shown in **Figure 2**. Use the 1" Spacers or $7/8$ " (22mm) Spacers to match the handlebar diameter if necessary.

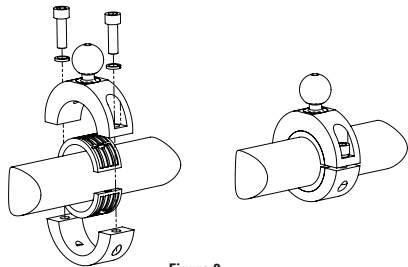

Figure 2

4. Using the $5/32$ " Hex Key, loosely reassemble the top portion of the Mount as shown in **Figure 3**.

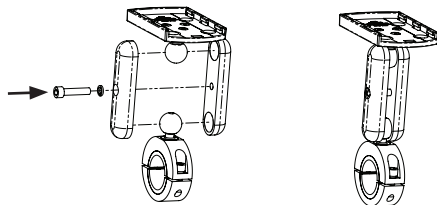



Figure 3

-  **Tip:** Wiring may be routed in between Links to aid in cable management.

5. Slide the Main Console (sold separately) onto the Mounting Plate as shown in **Figure 4**.

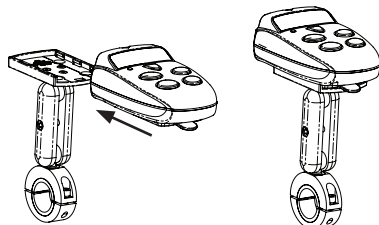





Figure 4

6. Adjust the Main Console and Mount to the desired position and tighten the *Positioning Screw* to lock the assembly in place.

-  **Tip:** For optimal performance, the Main Console should be horizontal to the ground and should not be obstructed by the gauges.

-  **Warning:** Verify that the position of the Main Console and Mount will not interfere with proper operation of the vehicle.

-  **Warning:** Make sure all screws are securely tightened before each ride so that the assembly will not move during use.

Adaptiv Technologies, LLC
459 Columbus Avenue
Suite 709
New York, NY 10024

www.RadarForBikes.com

866-ADAPTIV
(866-232-7848)